

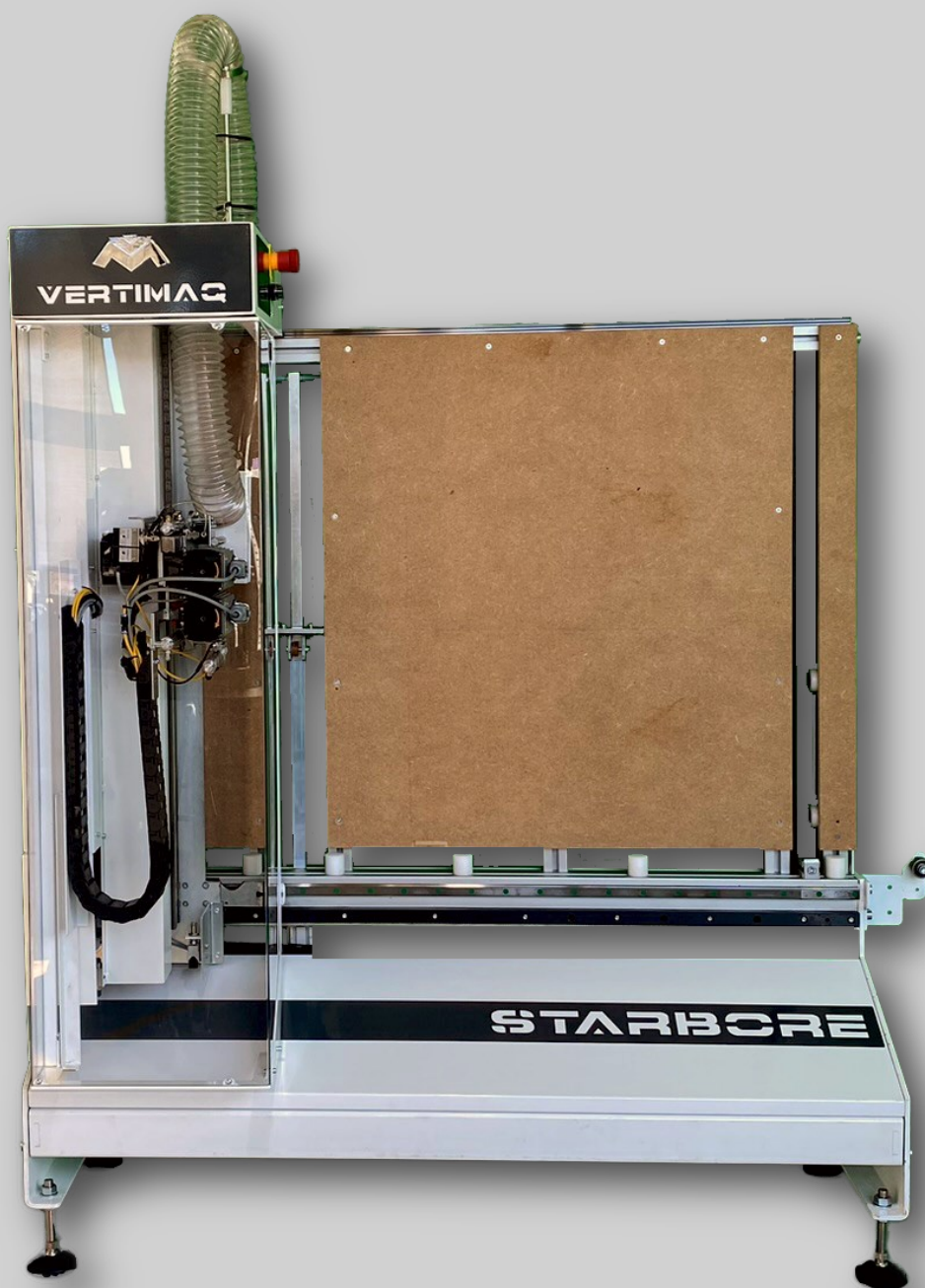

STARBORE

"Technology cnc for everyone"



Vertical Concept

All are advantages for your business
"CNC TECHNOLOGY FOR EVERYONE"

The vertical machine occupies less space, a really record, to have a cnc drill center in only 2 m2 of your workshop. The machined part always rest on one of the edges, his weight resides in that side avoiding scratches on its surface finish, the plastic table is behind the part, guiding it, so finally the external cabinet surface does not suffer any damage

Thanks to gravity, the piece always is in contact with the base with bearings, the zero point of all measures, does not need adjustable pusher, avoiding wasted time to set up the machine to each workpiece, as it happens in the horizontal machines.

All the dust generated by drilling falls down about gravity and it goes straight to the suction inlet located at the base of the machine.

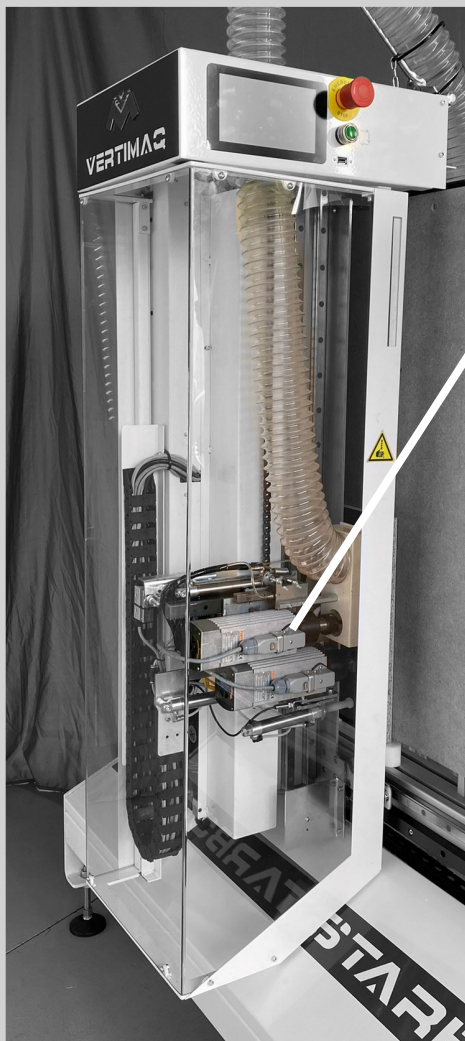

Transparency visual for work



- Weight supported in edge.
- Not scratching the workpiece surface as the horizontal systems

The friendly Software

The Gcode design Vertimaq , certainly one of the most intuitive woodworking software, provides easy use, speed and flexibility. From the comfort of your office, without to borrow machine time to programming, the part program is copied in a pendrive to put then in the cnc control , so by the menú selection or by reading the bar code, the program is loaded automatically, and pressing the green button, the part is mechanized.



After you fill the boxes with the measures information for the specific macro, the part desing is generated immediately, so simple like that!

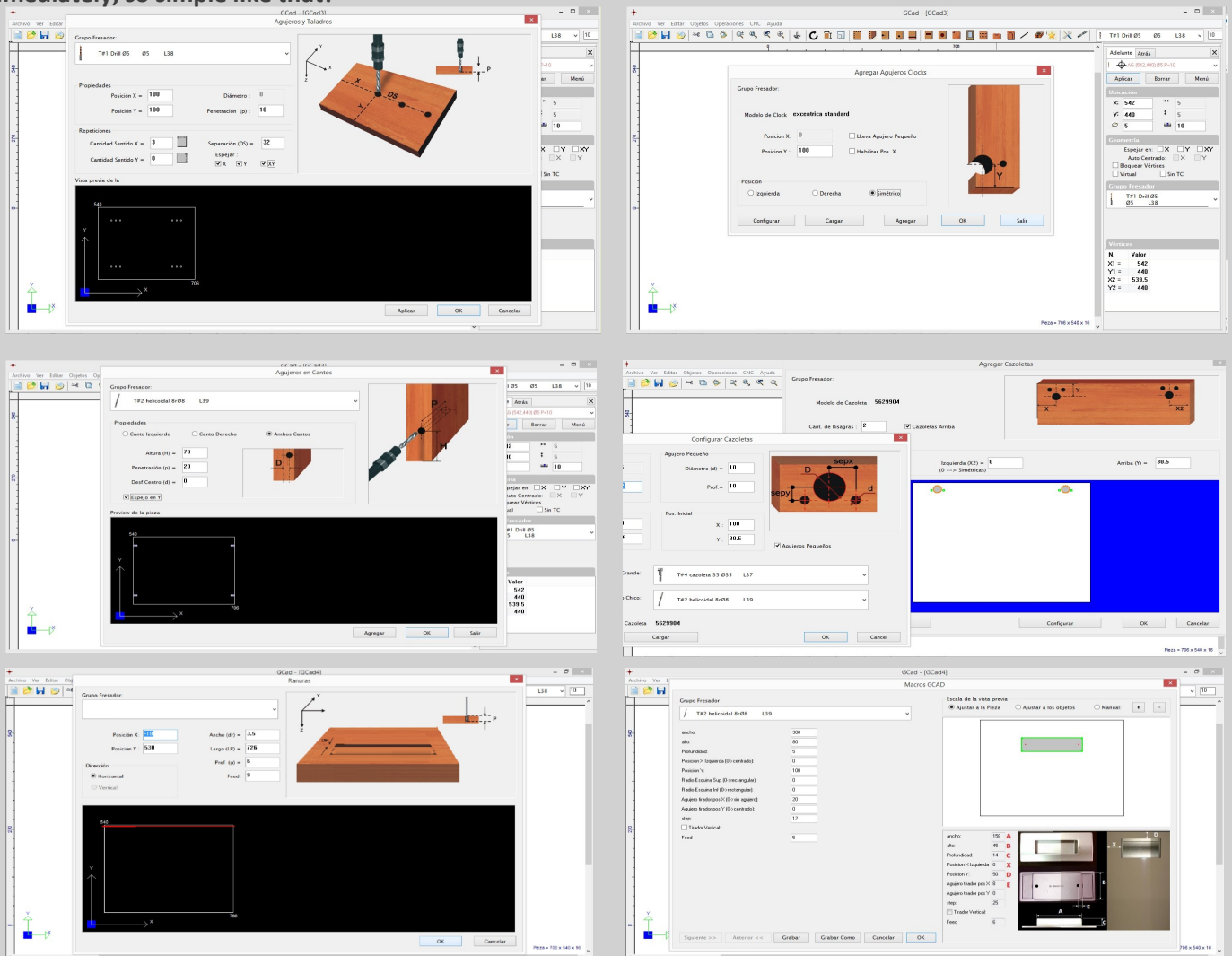

The screens can change based on the chosen version



STARBORE the new Vertimaq cnc drilling center, provides the craftsmen the state of the art in woodworking technology

Absolutely compact, easy to use and fully flexible.

It makes drills, grooves, millings, cuts... all you need for cabinets and furnitures, all that in only 2m2



The boringhead

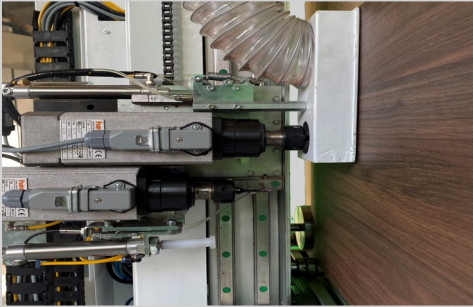

Spindle No. 1

Ø8 milling cutter as standard

(can be equipped with cutter up to Ø45)



Spindle No. 2

Ø5 drill bit as standard

(can be equipped with cutter up to Ø45)



Table for the holes in the edge of the piece

(up to 900mm height)

Probing system

A



B

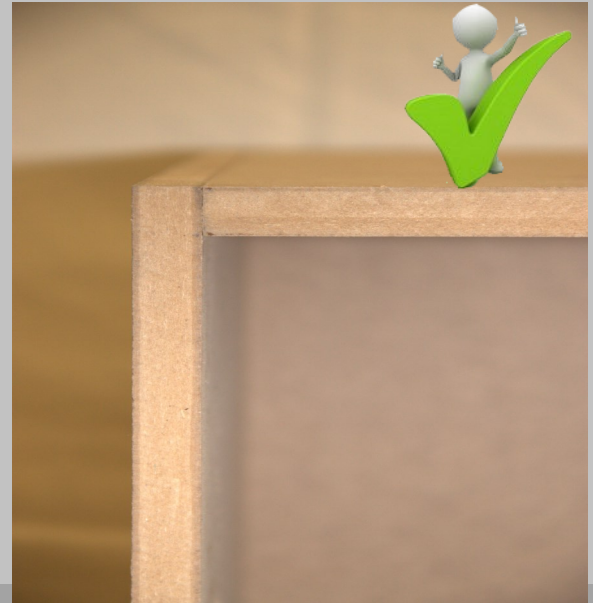
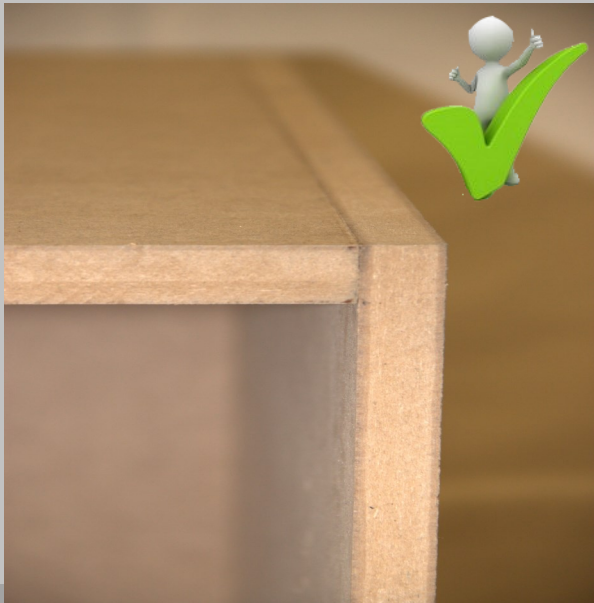

TECHNICAL DATA

STARBORE (dimensions in mm)	
Y-axis (maximum drilling position)	900
Maximum Grooving Height with Cutter	900
X axis	2600
Z axis (material thickness) (optional 10-50)	0-40
Máximum Speed displacement	15m/min
Minimum piece to machining.	(x)150 (y)30
Maximum piece height	920
Spindle motor (2 units)	1HP/ 18000rpm
Packaging : (mm)	1600x600x1700
Required air pressure	6 Kg/cm2
Weight approx (kg)	300

Examples for milling works :

- Holes of any diameter (interpolated milling).
- Eccentric holes (hardware for quick assembly)
- Kitchen hinge holes, configurable to any brand on the market
- Cutter slots in any direction
- Millings and drawings

Standard equipment

Vertimaq closed loop numerical control.

GCode Designer design program, specific for carpentry.

Configured to drill parts on the machine.

2 Milling Motor Units 1 hp / 18000rpm.

Voltage: Single phase 220V (inverter converts to three phase)

Electronic probe to correct the length of the piece and the position of the holes with respect to square deviations.

Centralized manual greasing (optional).



VERTIMAQ.S.L

C/ Lluís Dalmau 34
08850 Gava (Barcelona)

+34 931413108

info@vertimaq.com

www.vertimaq.com

https://www.youtube.com/user/vertimaq

https://twitter.com/vertimaq

FACTORY & SHOWROOM

C/ Penedes 45
08880 Cubelles (Barcelona)

+34 931372010



SCAN ME

